



PT CR607 CORNER ROUNDER

OPERATOR'S MANUAL

755 Griffith Court, Burlington, Ontario, L7L 5R9 Canada
(905) 633-7663 Toll Free: 1 (800) 265-3376
www.graphicwhizard.com

Table of Contents

Introduction	2
Safety Precautions	3
Specifications	4
Overview	5
Operation	7
Set-Up	7
Unpacking	7
Initial Operation	8
Corner Rounding	8
Selecting a Blade	8
Loading Stock	9
Cutting Stock	9
Foot Pedal	9
Cut Stick	10
Installing Cutting Blades.....	11
Top Cover	11
Cutter Assembly.....	11
Removing Blades.....	12
Troubleshooting.....	13
Red Light Indicator	13
Unable to Cut Through.....	14
Round Corner Adjustment	15
Maintenance	18
Cleaning.....	18
Lubrication	19
Wiring.....	20

Introduction



The **CR607** is equipped with an index turret multi-tool cutting system which provides a series of rounding radius from 2 to 10mm. The rounding radius can be chosen by rotating to a different cutting blade. It is used to round the corners of paper material up to 2.36" thick like cards, copy paper, etc. (**DO NOT** attempt to cut wood, plastic, or metals).

The machine contains 7 turret mounted cutting blades for rounding radius of 3mm, 4mm, 5mm, 6mm, 7mm, 8mm, and 9mm. It also contains one empty carrier slot for optional rounding sizes 2mm or 10mm and a straight cut, either of which can be installed as needed.

A crank mechanism is used to operate the movement of corner rounding blades. During one cycle, the rounding blades move downwards, cut, and return to the original position.

An inter-lock system is installed to ensure the safety of the operator. Three inter-lock switches are placed in different areas and prevent the machine from operating if problems occur.

To guarantee safety a minimum stack size of 1.75"x3.15" (45x80mm) is recommended. Any smaller size may cause a personal safety hazard. Use the foot pedal when working with a stack of paper larger than 5.8"x8.25" (148x210mm). A magnetic guide is provided to help align the stack to ensure a uniform rounded edge.

Safety Precautions

- ⊗ **DO NOT** disassemble the machine with the power cord plugged in.
- ⊗ **DO NOT** operate with more than one operator.
- ⊗ Always exercise caution when performing maintenance.
- ⊗ **DO NOT** modify the machine.
- ⊗ **DO NOT** disassemble the machine when the power is on.
- ⊗ **DO NOT** operate the machine when the cover is open.
- ⊗ When using a foot pedal, keep hands away from the working area.
- ⊗ **DO NOT** operate with wet hands.
- ⊗ **DO NOT** touch any moving parts when in operation.
- ⊗ **DO NOT** use alcohol or organic solvents to clean the machines.
- ⊗ **SWITCH OFF** the machine and **REMOVE THE POWER PLUG** before cleaning.
- ⊗ Clean the machine periodically to maintain best performance.
- ⊗ Install and position the machine on a **FLAT** and **STABLE** surface.
- ⊗ Avoid positioning the machine in a humid or dusty environment.
- ⊗ Avoid direct sunshine.
- ⊗ Avoid nearby heat sources.
- ⊗ Avoid toxic and corrosive environments.
- ⊗ **DO NOT** touch wires, boards, etc. when power cord is plugged in.

Specifications

While every effort was made at time of publication to ensure accuracy, Graphic Whizard Inc./Graphic Whizard USA Inc. will not be liable for omissions or errors. Specifications and information are subject to change without notice. Actual results are dependent upon application. Paper, print engine used, and environmental conditions will affect results.

Model Number	PT CR607
Power Supply	110-130V, 50/60Hz, 15A
Nominal Power	120W
Machine Dimensions (WxLxH)	13.9"x 20.3"x 28.3" 35.4x 51.8x71.9 cm
Weight	47 kg / 103 lbs
Operating Temperature	10-35°C / 50-95°F
Operating Humidity	30-70%
Feeding Method	Manual
Input Paper Size	<i>Min:</i> 45mm-80mm / 1.76"-3.15" <i>Max:</i> 148mm-210mm / 5.8"-8.25" <i>Thickness:</i> 2.36"
Tabletop/Floor:	Tabletop *Optional stand available

Overview

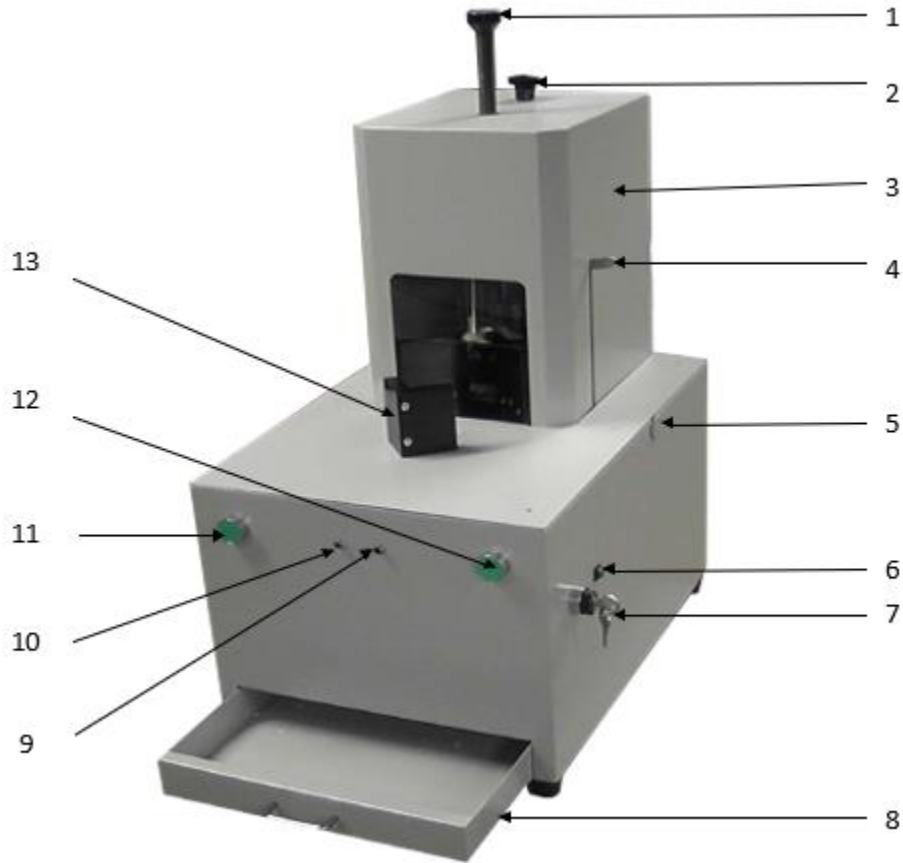

No	Name	Description	No	Name	Description
1	Cutter Index	Rotate to change blades	8	Waste Tray	Collect paper waste
2	Lock Screw	Lock down cover	9	Error Indicator	<i>Red light</i> - safety switch disabled
3	Top Cover	For protection	10	Power Indicator	<i>Green light</i> - power on
4	Lever	Unlocks cutter turret	11	Left Start Button	Press both buttons together to cycle the cutter once
5	Cut Stick Lock	Unlock cut stick tool	12	Right Start Button	
6	Inching Button	Inching cutter up/down	13	Magnetic Side Guide	Secures stack in place/safety feature
7	Switch Key	Power on/off			

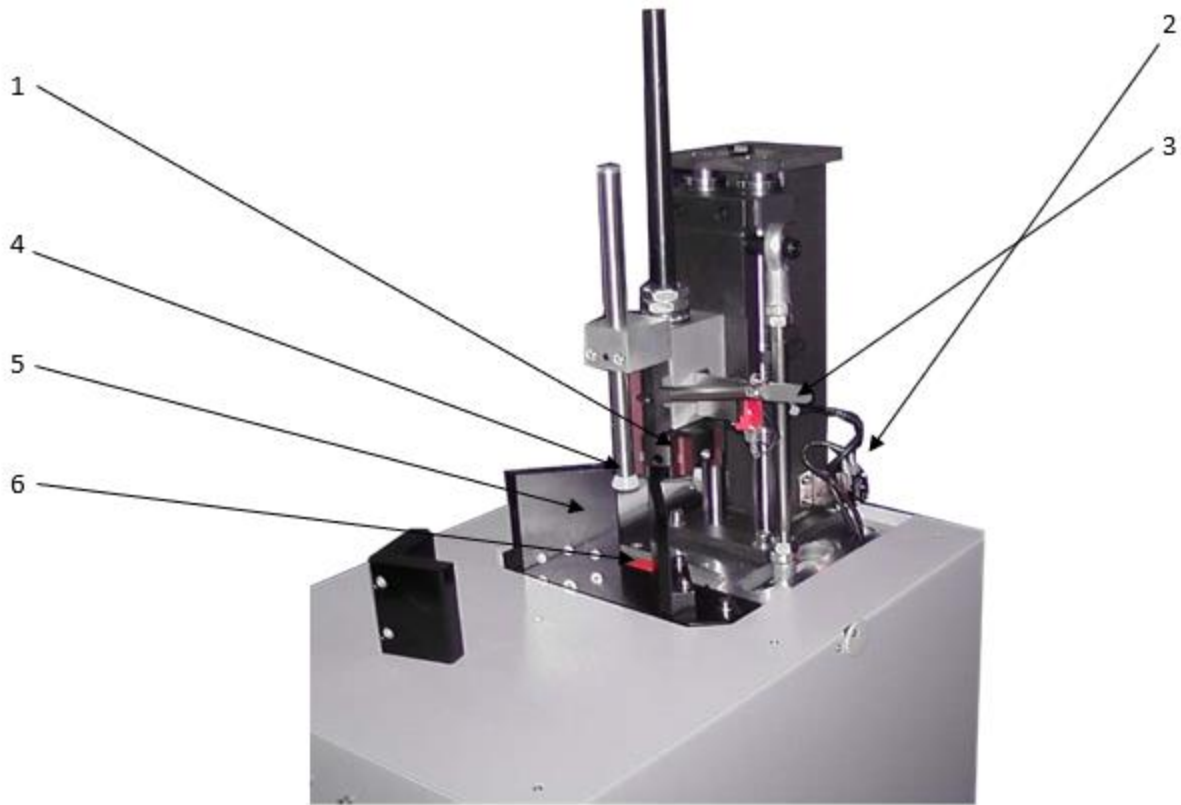

No	Name	Description
1	Cutter Blade Turret	Rotating turret with 7 blades
2	Top Cover Safety Switch	For maintenance
3	Lever Switch	Press down to rotate blade turret
4	Card Press	Holds stack in place
5	Fixed Side Guides	Guides stack in place
6	Cut Stick	Consumable item that the cutting blade strikes when completing a cycle

Operation

Set-Up

The following items listed below are included with the machine. If any one of them is missing, please contact your dealer.

Name	Quantity
Allen Key (2.5mm)	1
Allen Key (4mm)	1
Extra Cut Sticks	5
Main Switch Key	2
Operation Manual	1
Magnetic Stopper	1
Power Cord	1
Foot Pedal	1
Blades (3mm, 4mm, 5mm, 6mm, 7mm, 8mm, and 9mm)	2 each - 14 total
Radius Guides	2

Unpacking

- Unscrew and remove wooden crate.
- At least two individuals capable of lifting 50 lbs each are required to lift the unit of the pallet.
- Place the PT CR607 on a flat surface such as the optional stand or a table.
- Inspect the machine for the above listed parts and accessories.

Initial Operation

- The PT CR607 is shipped with the cutting tool in the down position to avoid possible damage in transit.
- Attach power cord to socket at rear of the unit. Plug in to a receptacle (110v). There is also a 3.15A fuse located in the socket.
- Insert the key and turn clockwise to power on.
- To operate the machine, the user must first return the cutting tool to its home position.
- Press the two-handed operation green Start buttons. The cutting tool will cycle to the up/home position.
- Use caution. Do not place hands/fingers near cutting area as blades are sharp.
- The machine is now ready for use.

Corner Rounding



Selecting a Blade

With the power off press the lever down at the side of the cover. Choose the radius by rotating the shaft at the top of the machine. The radius size is indicated on the shaft and will face the operator once locked in place.

When you hear a click sound that means the cutter is locked and ready to cut.

The face of blade is also marked with the radius size for operator convenience.



Cutter in place

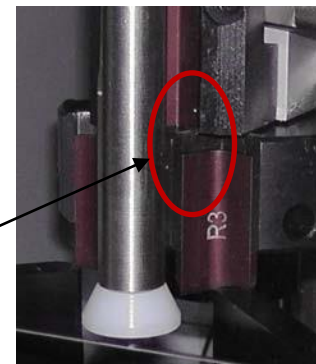

Cutter not in place

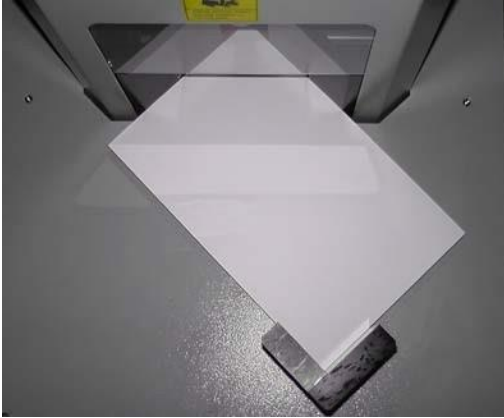

Loading Stock

Insert a stack of cards in between the fixed side guides. Place magnetic guide at the open end of stack for safety. This will also keep stack tight to achieve straight cuts.

Cutting Stock

After loading stock press both green Start buttons to activate the cutter. The machine will cycle once.

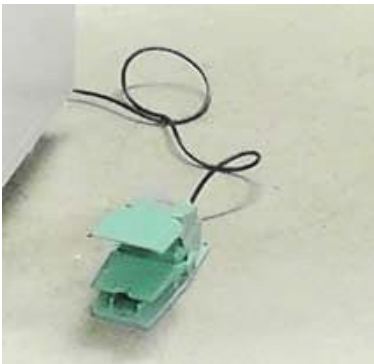

Foot Pedal

Use the foot pedal to activate the cutter when rounding larger stock that requires the operator to hold onto the paper.

CAUTION: NEVER PLACE HANDS/FINGERS NEAR BLADES WHEN IN OPERATION!!!

Cut Stick

The cut stick can be rotated or replaced when needed. Pull back and hold the spring loaded cut stick lock on the side of the machine.



Remove the cut stick to rotate or replace. Next replace the cut stick by installing it on the holder.

Use the hole in the center of the stick to thread the locking shaft. Release the cut stick lock and the shaft to secure the cut stick back into position.

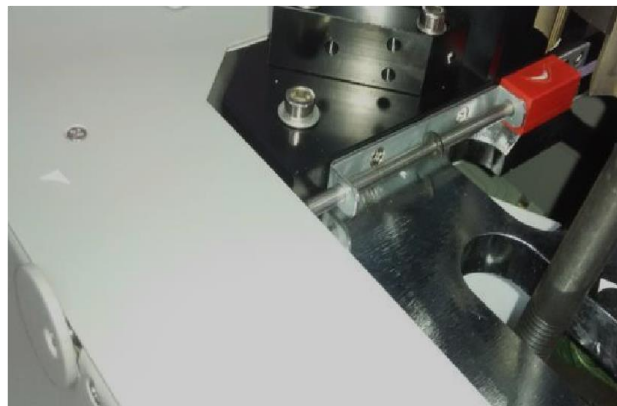

Installing Cutting Blades

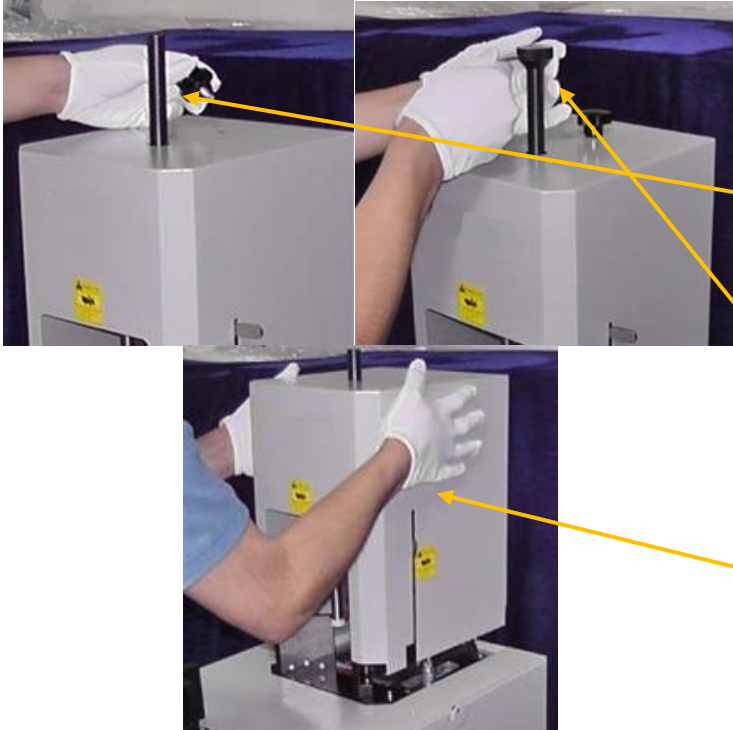

Top Cover

First, remove the top cover by removing the securing knob from the top of the cover.

Next, remove the turret handle knob using a 2mm Allen key (provided). This will expose the turret assembly.

Finally, slide off the safety cover. This will expose the blade turret assembly.

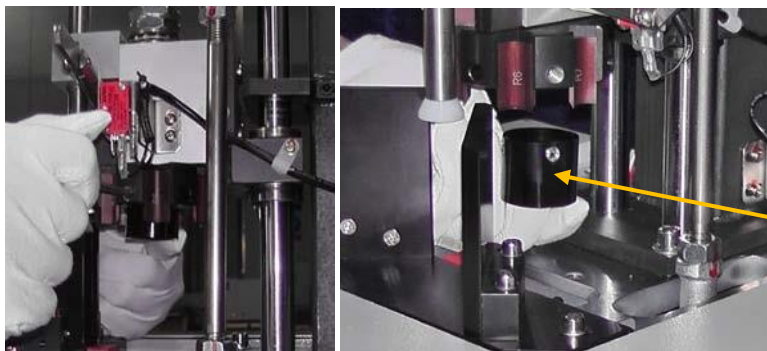

Cutter Assembly

Loosen the two set screws to remove the round black metal waste deflector located inside the base of the cutter turret. This will provide access to the blade screws.

Removing Blades

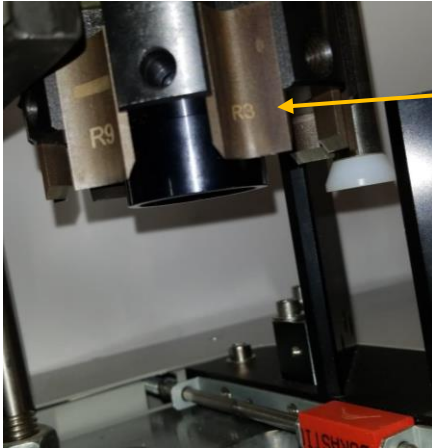

Identify the blade that requires removal. The blades should be labeled according to size (R3-R9). The blade is secured in the turret with a set screw that is fed from the rear. Rotate the turret to access the set screw once you know the location of the blade.

Note: Two of the blades set screws are behind the screws that secure the black collar. When replacing one of these blades, you will have to remove the set screw for the waste deflector before you can access the set screw that secures the blade.

Loosen the set screw behind the blade and remove the blade using the provided 4mm T-handle Allen tool. Insert the new blade by feeding it from the top. Carefully pull down on the blade to remove if it does not easily slide out.

Note: You do not have to completely remove the screw. Loosen it enough to remove the blade.

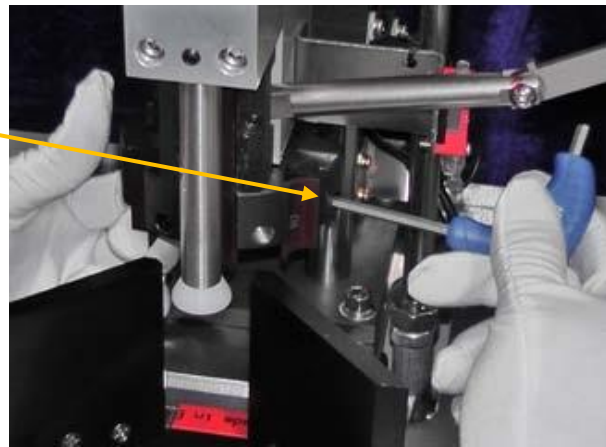

Using the metal radius guide that came with the corner rounder, adjust the blade depth by gently holding the plate flat against the blades. This will ensure the new blade is at the same height as the rest of the blades.

Once set, tighten the screw. Replace the metal collar. Replace the cover. Test the new blade for cut accuracy.

Troubleshooting

Red Light Indicator

If the red light on the front of the PT CR607 is lit the machine will not run. The following steps are designed to help correct the issue.

- Make sure the power cord is connected.
- Restart the machine by switching off/on the main switch. If problem still exists, go to next step.
- Make sure the tool-switch lever is in the proper position and the inter-lock switch located inside is pressed by the lever.

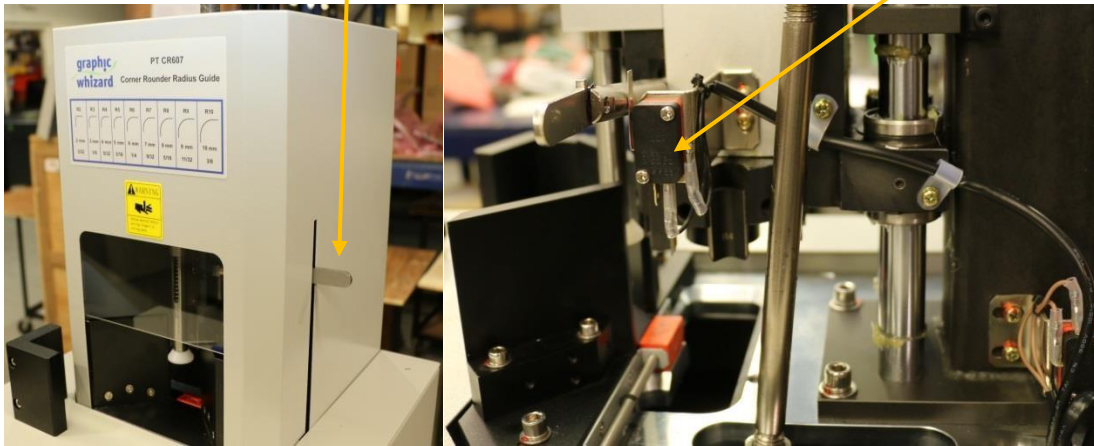

- Make sure the waste tray is closed and the inter-lock switch located inside is pressed by the tray.

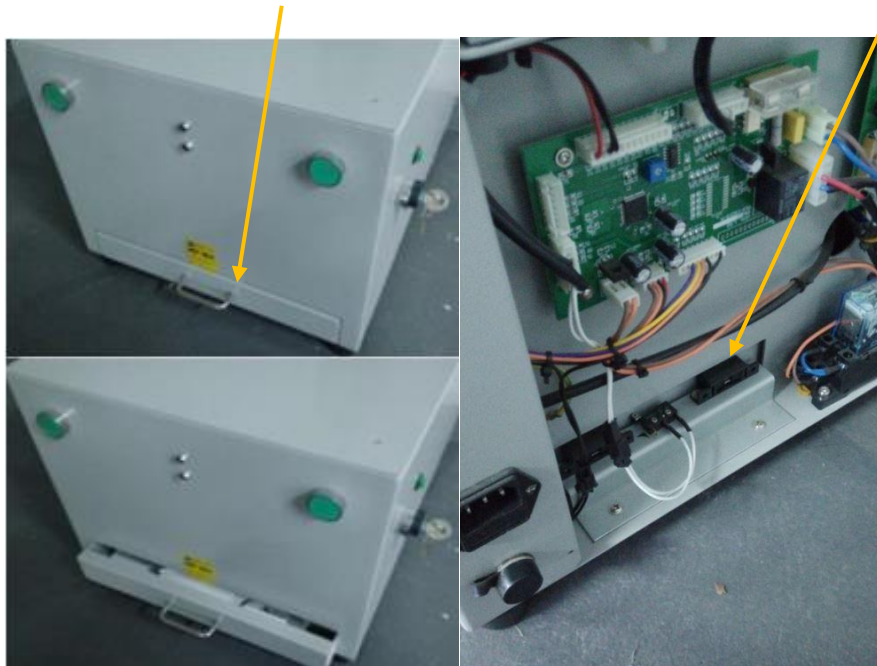

- Make sure the top cover is securely in place and the inter-lock switch inside is pressed by the cover. Ensure the cover is sitting flush for the switch to be activated.

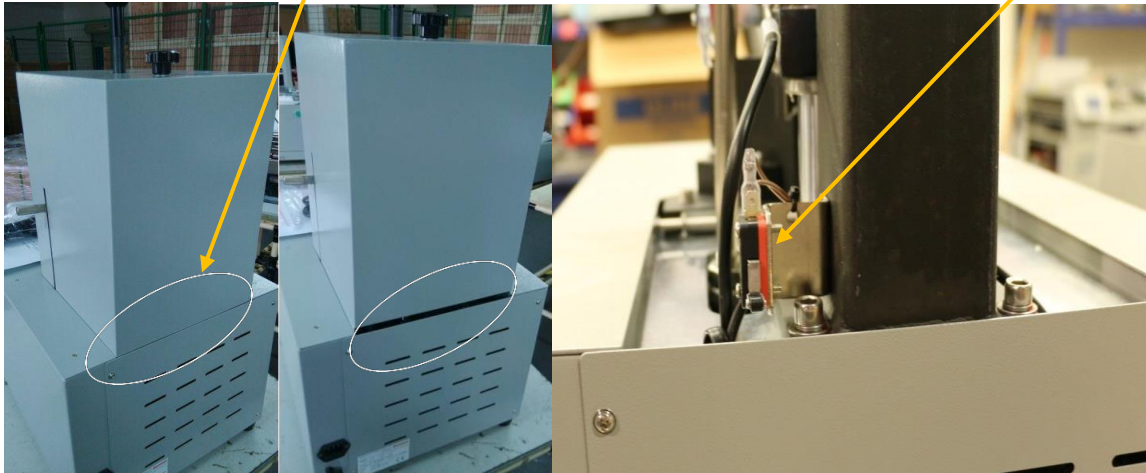

- Please contact your dealer if any problems still exist after attempting the previous steps.

⚠️ WARNING ⚠️

Inter-lock switches are designed and installed to guarantee the safety of the operator. The machine is designed to not function with unsecured inter-lock switches.

Unable to Cut Through

- **Decrease the thickness of the stack.** The stack height may need to be smaller if the stock is harder/thicker than average.
- **Replace the cutting blade.** The cutting blade is a consumable which means it may have a significant decrease in performance due to normal operational wear. Replace when needed.
- **Reposition the cutting blades.** The cutting may be influenced by the starting position of the cutting blades. The cutting performance may be less than perfect when the starting position is close to the stock.
- **Replace the cut stick.** The cut stick is a consumable part which means after prolonged use it may wear beyond desired usage.

Round Corner Adjustment



Overcut (Left)

Proper Cut (Middle)

Undercut (Right)

The finished products can be classified into three types: overcut products, undercut products and proper products. Overcut and undercut are caused if the side guides are not aligned. They may need to be micro-adjusted to obtain a desirable product.



To realign the side guides first switch off the power. Remove the main switch key and unplug the power cord before removing the cover.

After removing cover bypass cover safety switch and turn the power back and for adjustment purposes only.

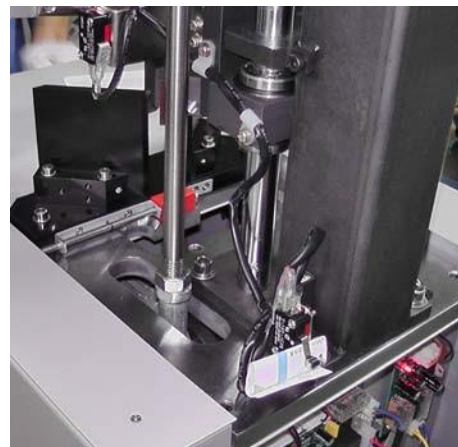

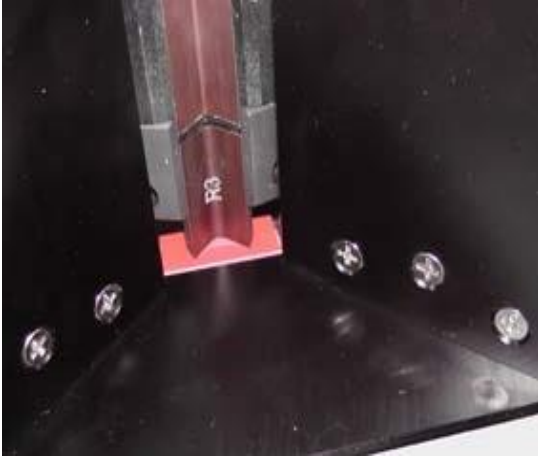

Use the Inching button to bring the cutting blade all the way down to the cut stick.

Loosen the two screws on the back of the guide (not the front) using a 4mm Allen key.



Do not remove the screws or the guides from the machine. This will allow the operator to shift the guides into position.

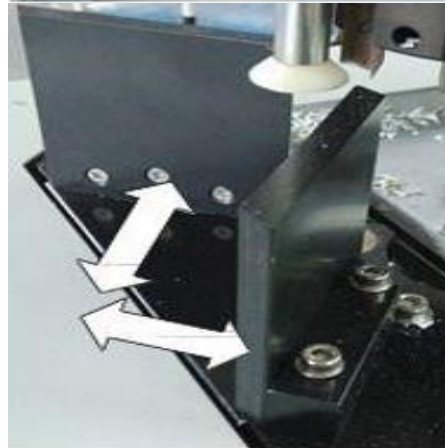

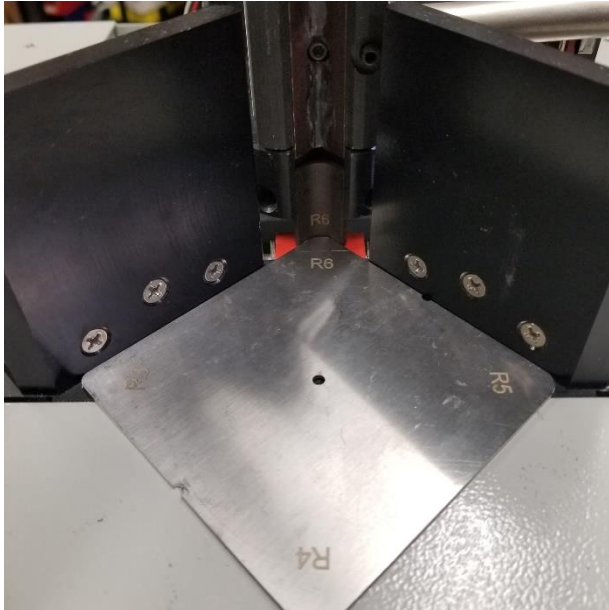

Use the radius guide to align the side guides to the proper blade radius. Each corner of the radius guide is cut and labelled to match the blades. This is a very delicate process and may take time to accurately align the side guides.

After aligning the side guides tighten the side guide screws. Next test the cutting on card stock. When satisfied with results return the inter-lock switch back to original position. The PT CR607 will not work if this step is not completed. Replace the cover when complete.



Maintenance

Cleaning

Dust or paper clippings should be cleaned after each use. Use compressed air or a brush to clean surfaces. Dump the waste tray into the trash. Make sure the tray is replaced in the proper position to activate the inter-lock switch.

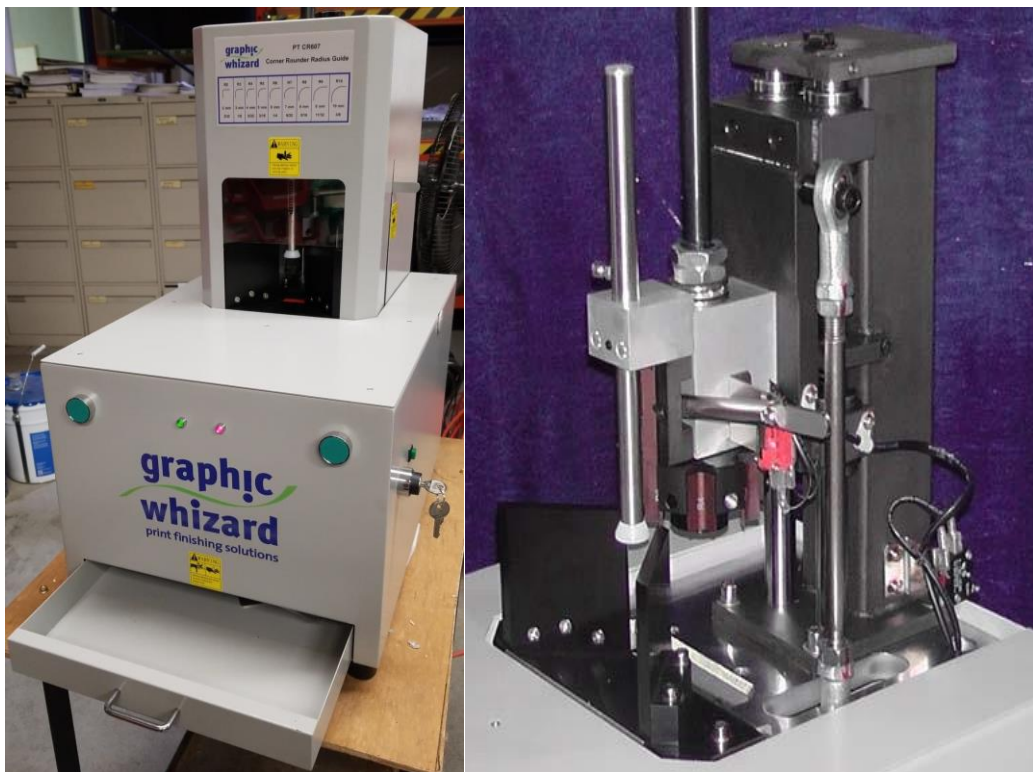

Lubrication

Regularly lubricate bearings and shafts with 3-in-1 Oil or motor grease. This will ensure smooth operation of the PT CR607.

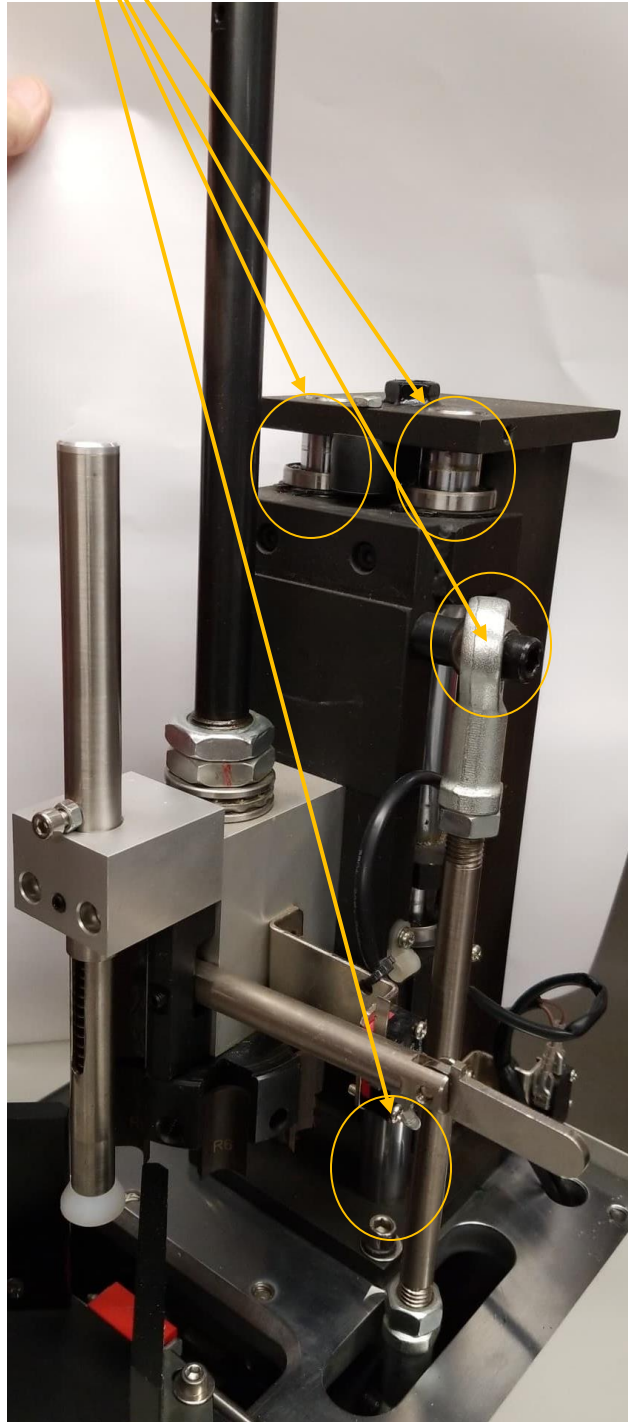

Wiring

